

SOUNDCLIP-A



Instructions for Use

bernafon[®]
Your hearing • Our passion

Introduction to this booklet

This booklet guides you on how to use and maintain your new SoundClip-A. Please read the booklet carefully, including the Warnings section. This will help you to get the most out of your new SoundClip-A.

If you have additional questions about the use of your SoundClip-A, please contact your hearing care professional.

Intended use

Intended use:	SoundClip-A is intended as a wireless receiver and transmitter of sound between Bernafon wireless hearing aids and the surrounding environment, including speech and wireless electronic audio devices. SoundClip-A furthermore assists hearing aids users to control the functionality provided by their hearing aid.
Indications for use:	No indications for use.
Intended user:	Adults and children older than 36 months.
Use environment:	Indoor / Outdoor.
Contraindications:	Users of active implants must pay special attention when using the device. For more information, read the Warning section.
Clinical benefits:	See clinical benefits of the hearing aid.

Important Notice

Please familiarize yourself with the entire contents of this booklet before using your SoundClip-A. It contains instructions and important information about the use and handling of your SoundClip-A.

Introduction

The SoundClip-A can be used both as a wireless headset for mobile phones and as a remote microphone/partner microphone.

1. Headset with mobile phone

Sounds from your phone will be streamed to your hearing aids through the SoundClip-A (A). Your voice is picked up by the SoundClip-A and sent to the mobile phone (B).

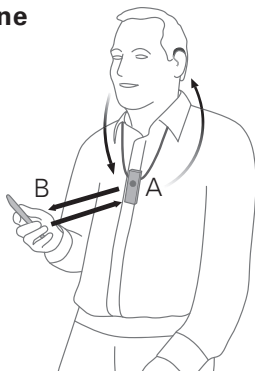

2. Remote/partner-microphone

The voice of a chosen speaker will be transmitted wirelessly from the SoundClip-A to your hearing aids.

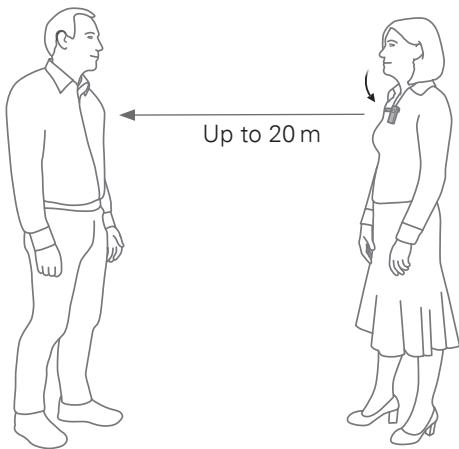
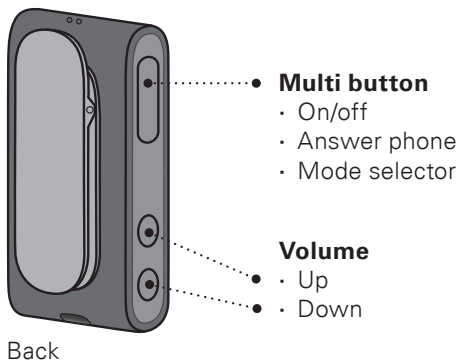
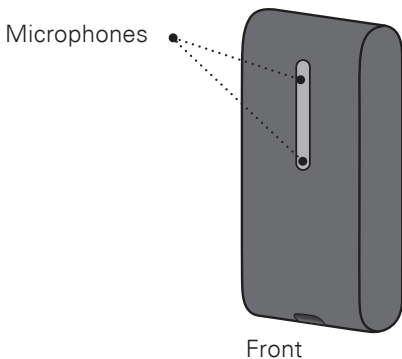

Table of contents

Overview – main functions	10
Overview – product indicators	12
Getting started	14
Daily use: On/Off	20
Daily use: Charging	21
Using SoundClip-A with a mobile phone	23
Ensuring SoundClip-A is connected to the phone	24
Receiving calls	25
Making calls	27
Advanced headset features	28
Listening to music	29
Using SoundClip-A as remote microphone	31
Selecting microphone mode	32
Starting/stopping sound from remote microphone	33
Regulating level from remote microphone	34
Starting/stopping sound from remote microphone using your hearing aids	35

Using SoundClip-A as remote control for hearing aids	36
Other features and functions	37
Cleaning the SoundClip-A	38
Warnings	39
Technical information	46
International warranty	51

Overview – main functions



Status indicator

Power indicator

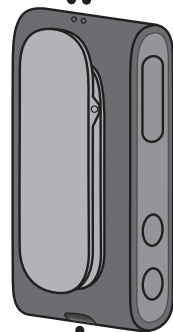

Charging socket (Micro USB)

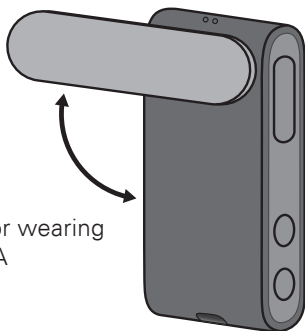

Clip (rotating) for wearing
the SoundClip-A

Overview – product indicators

Status indicator	Mode
Blinking yellow	Searching for hearing aids
Steady yellow	Idle. Hearing aids connected, not connected to a phone.
Blinking blue	Searching for a mobile phone (pairing)
Steady blue	Connected to a mobile phone
Steady green	In a call
Blinking green	Incoming call
Steady orange	Streaming music
Steady magenta	Remote microphone mode
Blinking magenta	Remote microphone reconnecting

Power indicator	Mode
Steady red	Battery low
Steady green	Turned on – not charging
Blinking green	Turned on – charging
Fading green	Turned on – charging complete
Blinking orange	Turned off – charging
Steady orange	Turned off – charging complete
No light	Power off

Getting started

Before you can use the SoundClip-A with your hearing aids, both the hearing aids and the SoundClip-A need to be paired/connected. Using the SoundClip-A with a mobile phone also requires the SoundClip-A to be paired with/connected to your mobile phone.

A. Pairing hearing aids and SoundClip-A

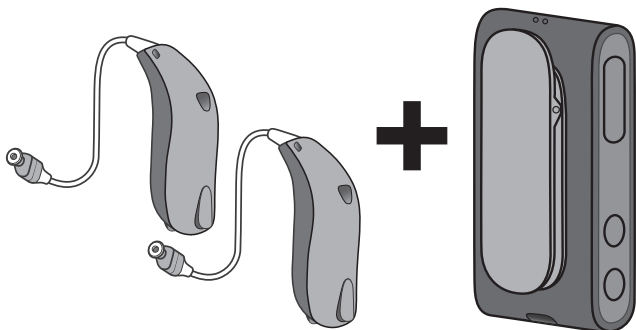

See page 16 for detailed instructions about pairing a SoundClip-A with your hearing aids

B. Pairing SoundClip-A and mobile phone

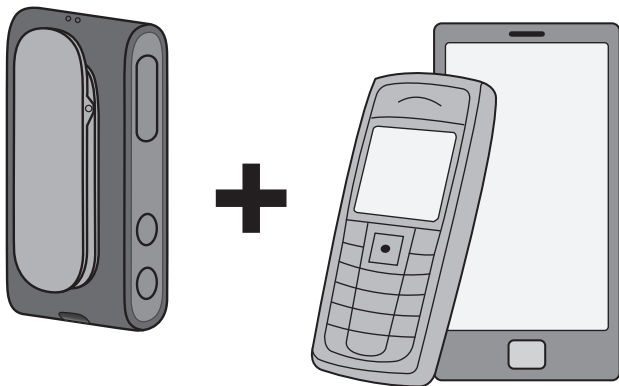

See page 18 for detailed instructions about pairing a SoundClip-A with your mobile phone

A. Pairing hearing aids with the SoundClip-A

1. Ensure SoundClip-A is powered off

Press and hold multi button for approx. 6 seconds until the power indicator is **OFF**.

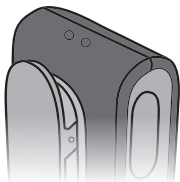

2. Turn both hearing aids OFF

(open battery drawer)

3. Turn both hearing aids ON

(close battery drawer)

The hearing aids will now be ready for first time connection with the SoundClip-A. You now have 3 minutes to complete the pairing.

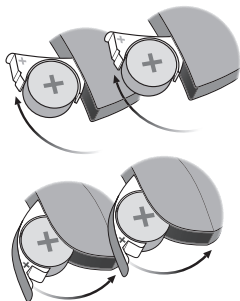

4. Turn ON SoundClip-A

Press and hold multi button for approx. 3 seconds until power indicator shows **STEADY GREEN**.

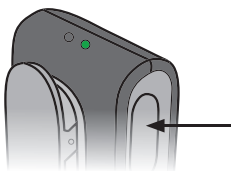

5. SoundClip-A will now search for your hearing aids

Status indicator will be **BLINKING YELLOW**.

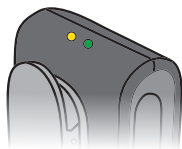

6. Place SoundClip-A and both hearing aids close to each other

(max. distance 20 cm)

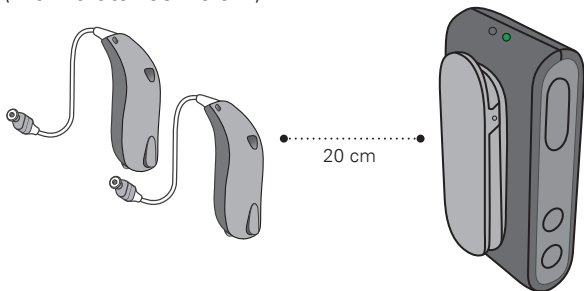

7. Connection established with hearing aid(s)

is indicated by status indicator **STEADY YELLOW**.



B. Pairing mobile phone with the SoundClip-A

1. Place SoundClip-A in pairing mode

Press and hold the multi button AND volume up button for about 6 seconds (A) until status indicator **BLINKS BLUE**.

2. The SoundClip-A will be in pairing mode for about 3 minutes

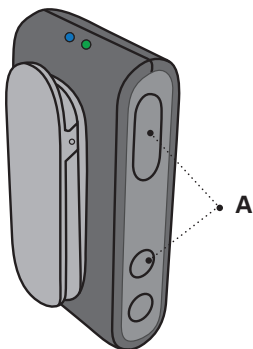

3. Enable pairing on mobile phone

Turn on Bluetooth®. Search for and connect to/pair with SoundClip-A.

This is normally in the settings → Bluetooth® section of your phone.

4. Enter pin code

If your phone requests a pin code, enter 0000 (four zeros).

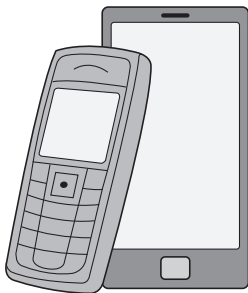

5. Pairing complete

Pairing complete with mobile phone is indicated by status indicator **STEADY BLUE**.



Daily use: On/Off

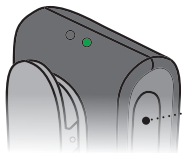

ON

Press and hold multi button for approx. 3 seconds until power indicator shows **STEADY GREEN**.

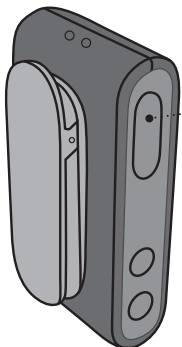

OFF

Press and hold multi button for approx. 6 seconds until power indicator is **OFF**.

Daily use: Charging

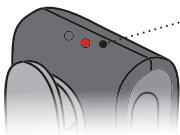

- **Battery low**

With about 30 minutes remaining streaming time, the power indicator turns **RED**.



- **Charging**

Connect the enclosed charger through the micro USB connector in the bottom of the SoundClip-A. The power indicator **BLINKS GREEN** or **ORANGE**.

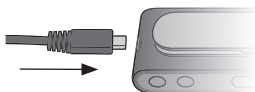

Power indicator	Mode
Blinking green	Turned on - charging
Fading green	Turned on - charging complete
Blinking orange	Turned off - charging
Steady orange	Turned off - charging complete

Important Notice

When charging, the charging indicator should be lit as described in this booklet. If the charging indicator is not lit as described, disconnect the device from the charger and consult your hearing care professional.

Important Notice

When charging the SoundClip-A use the supplied original power supply 5.0V/1A, CE and safety marked.



Using SoundClip-A with a mobile phone

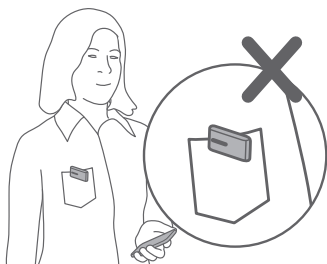
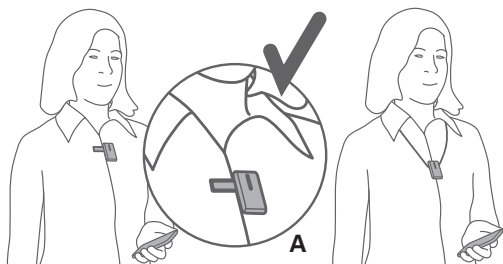

Important Notice

The SoundClip-A should be worn as indicated for best possible performance. It is important that the microphone in the SoundClip-A is pointing towards your mouth (A), and that the SoundClip-A is not covered by clothes etc. Maximum distance between SoundClip-A and mobile phone is 10 meters.

Ensuring SoundClip-A is connected to the phone

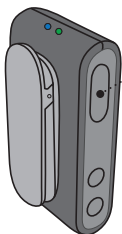

Select phone mode

Press and hold multi button for approx. 3 seconds to change mode. Mode change is confirmed by an audible indication in your hearing aids. The status indicator is **STEADY BLUE**.



Status Indicator	Mode
Steady yellow	Idle. Hearing aids connected, not connected to a phone
Steady Blue	Connected to mobile phone
Steady Magenta	Remote microphone mode

Receiving calls

Phone connected

When the SoundClip-A is turned on and in range of your mobile phone it will automatically connect to the mobile phone.

The status indicator is **STEADY BLUE**.

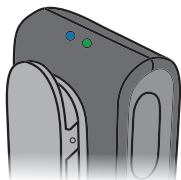

Phone ringing

When the phone rings you will hear a ring indicator (and if available, the ring-tone from your phone) in your hearing aids.



The status indicator will **BLINK GREEN**.



- **Answer call**

Either click the multi button (A) shortly – or answer the call from your mobile phone. Once the call is connected, the status indicator will change to **STEADY GREEN.**



- **End call**

Either click the multi button (A) shortly – or hang up the call from your mobile phone. Status indicator is **STEADY BLUE.**

Making calls

To make a call you only have to use the mobile phone. The call will automatically be connected to the SoundClip-A.

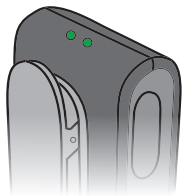

Once the call is connected the status indicator will change to **STEADY GREEN**.

Advanced headset features

Voice dialing / voice command

When connected to a mobile phone, double press on the multi button activates voice dialing if supported by the phone.

Reject call

A long press on the volume down button, while the phone is ringing, rejects the call.

Mute hearing aid microphones

Press and hold volume down for about 3 seconds to mute the hearing aid microphones.

Short press volume up or down will unmute hearing aids.

Listening to music

Wireless audio (A2DP)

If connected to a mobile phone, or other device, through Bluetooth[®], the music played on the phone/device will automatically be played in your hearing aids.

Status indicator is **STEADY ORANGE**.

You do not need to operate anything on the SoundClip-A.

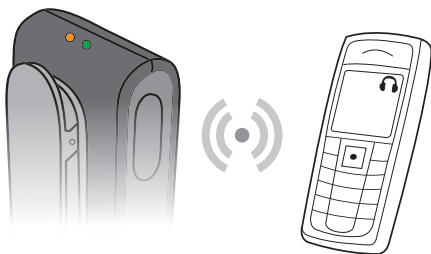

Status Indicator	Mode
Steady Orange	Streaming music

Adjusting volume

While listening to music, the level of the streamed signal can be adjusted using the volume up/down buttons.

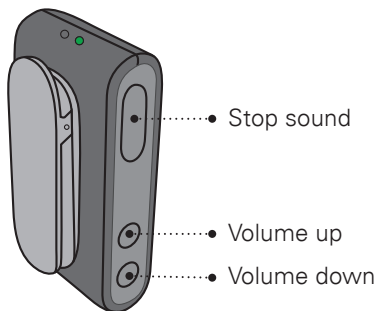

Stopping sound from phone

Short press on the multi button will stop sound.
Use the controls on the phone to start the sound.

Using SoundClip-A as remote microphone

Remote microphone

In this mode speech from the person wearing the SoundClip-A will be streamed directly to your hearing aids.

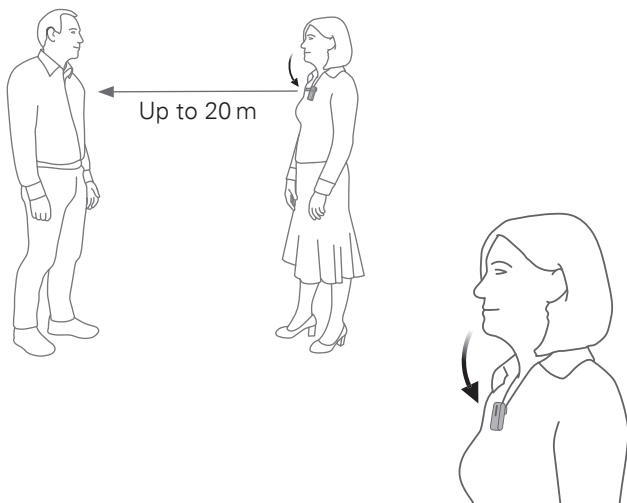

Important Notice

Ensure that the microphone is pointing to the speaker's mouth and that it is not covered by clothes etc.

Selecting microphone mode

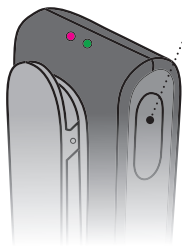

- **Select microphone mode**

Press and hold multi button for approx. 3 seconds to change mode.

Mode change is confirmed by an audible indication in your hearing aids.



Status indicator is
STEADY MAGENTA.

Status Indicator	Mode
Steady yellow	Idle. Hearing aids connected, not connected to a phone
Steady Blue	Connected to mobile phone
Steady Magnenta	Remote microphone mode

Starting/stopping sound from remote microphone

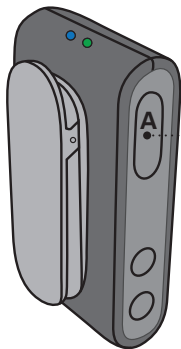

- **Stop sound from microphone**

Press and hold multi button (A) for approx. 3 seconds to stop the signal from the microphone to the hearing aids and switch the hearing aids back to their normal program.

The status indicator will change to **STEADY YELLOW** or **STEADY BLUE**.

Regulating level from remote microphone

Volume up or volume down

The streamed signal can be adjusted using the volume up/down buttons.

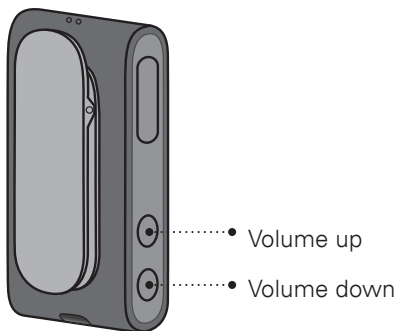

Mute hearing aid microphones (only sound from the remote microphone)

Press and hold volume down for about 3 seconds to mute the hearing aid microphones.

Short press volume up or down will unmute hearing aids.

Starting/stopping sound from remote microphone using your hearing aids

P1 -> P2 -> TV -> Microphone

A press on the hearing aid button will toggle to the next program in the hearing aids.

Once you reach the remote microphone program you will hear the remote microphone program indicator.



To stop remote microphone sound simply toggle back to wanted hearing aid program.

Important Notice

Please refer to your hearing aids instructions for use for details on the functionality of your specific hearing aid solution.

Using SoundClip-A as remote control for hearing aids



When SoundClip-A is not streaming sound it doubles as a remote control for your hearing aids.

- **Volume up**
 - Short press
- **Volume down**
 - Short press



- **Next program**
 - Press and hold for 3 seconds for next program
- **Mute hearing aid microphones – long press**
 - Short press on volume up or down will unmute

Important Notice

Maximum distance between SoundClip-A and hearing aids is 2 meters.

Other features and functions

One connection at a time

When paired with several devices (up to eight), the SoundClip-A will only connect to the first phone available/in range.

No calls when used as microphone

When using the SoundClip-A as partner/remote microphone, there will be no connection to the mobile phone.

Timeout (out of range) when in microphone mode

If the SoundClip-A is out of range of the hearing aids, the hearing aids will return to their initial program after 90 seconds.

Clear Bluetooth® pairings

Press and hold multi button, volume up and volume down for 10 seconds to clear all Bluetooth® pairings. Clearing completed is indicated by status indicator **BLINKING RED**.

Cleaning the SoundClip-A

Use a soft, dry cloth to clean the SoundClip-A.

Important Notice

The SoundClip-A must never be washed or immersed in water or other liquids.

Warnings

For your personal safety and to ensure correct usage, you should familiarise yourself fully with the following general warnings before using your SoundClip-A. Consult your hearing care professional if you experience unexpected operations or serious incidents with your SoundClip-A during use or because of its use. Your hearing care professional will support you with issue handling and, if relevant, reporting to the manufacturer and/or the national authorities.

Choking hazards and risk of swallowing small parts

The SoundClip-A should be kept out of reach of children and anyone who might swallow these items or otherwise cause injury to themselves. If a SoundClip-A is swallowed, see a doctor immediately.

Explosives

The SoundClip-A is safe to use under normal usage conditions. The SoundClip-A has not been tested for compliance with international standards concerning explosive environments.

Therefore, do not use your SoundClip-A in environments with danger of explosions e.g. mines, oxygen rich environments or areas where flammable anaesthetics are handled.

X-ray/CT/MR/PET scanning, electrotherapy and surgery

Remove your SoundClip-A before X-ray/CT/MR/PET scannings, electrotherapy, surgery, etc. as your SoundClip-A may be damaged when exposed to strong fields.

Heat and chemicals

The SoundClip-A must never be exposed to extreme heat e.g. left inside a parked car in the sun. The SoundClip-A must not be dried in microwave ovens or other ovens. The chemicals in cosmetics, hairspray, perfume, aftershave lotion, suntan lotion and insect repellent can damage the SoundClip-A. Always remove your SoundClip-A before applying such products and allow time to dry before use.

Warnings

Interference

The SoundClip-A has been thoroughly tested for interference according to the most stringent international standards. However, interference between the SoundClip-A and other devices (e.g. some mobile telephones, citizens band devices, shop alarm systems and other wireless devices) may occur. If this occurs, increase the distance between the SoundClip-A and the interfering device.

Use in traffic

Using the SoundClip-A can distract you. Be aware of your surroundings while using the SoundClip-A. Please refer to national traffic laws regarding the use of communication devices while in traffic.

Use on aircraft

Your SoundClip-A contains Bluetooth®. The SoundClip-A should not be used on board an aircraft, unless specifically permitted by the flight personnel.

Active implants

The SoundClip-A has been thoroughly tested and characterised for human health according to international standards for human exposure (Specific Absorption Ratio – SAR), induced electromagnetic power and voltages into the human body.

The exposure values are well below international accepted safety limits for SAR, induced electromagnetic power and voltages into the human body defined in the standards for human health and coexistence with active medical implants, such as pacemakers and heart defibrillators.

Rechargeable battery

Do not attempt to open the SoundClip-A, as this may damage the battery.

Never attempt to replace the battery. If battery replacement is needed, please return device to the supplier. The service guarantee is void if there are signs of tampering.

Warnings

The safety of recharging batteries using a USB connector is determined by the external signal source. When connected to external equipment plugged into a wall outlet, this equipment must comply with IEC62368-1 or equivalent safety standards.

Connection to external equipment

The safety of the use of SoundClip-A when connected to external equipment (via auxiliary input cable, via USB cable, or directly), is determined by the external equipment. When connected to external equipment plugged into a wall outlet, this equipment must comply with IEC-62368-1 or equivalent safety standards.

Cross control

Your SoundClip-A should be kept out of reach of children or anyone who might take control of the functionality, to ensure your personal safety and avoid incorrect use.

Use of lanyard

If by accident the lanyard is caught on something while wearing it, the lanyard is designed to break automatically. Therefore, never try to shorten or

modify the lanyard in an unauthorized way. The lanyard should not be used by children under 36 months of age.

Possible side effects

The otherwise non-allergenic materials used in your SoundClip-A may in rare cases cause a skin irritation or other side effects. Please, seek consultation with a physician if these conditions occur.

Incompatible non-supplied accessories

Only use accessories, transducers or cables supplied by the manufacturer. Incompatible accessories may result in reduced electromagnetic compatibility (EMC) of your device.

Charging

To prevent potential battery damage during storage please charge the SoundClip-A every 6 months.

Warnings

Mobile phone compatibility

Please refer to

www.bernafon.com/products/accessories for a list of mobile phones that have been tested comprehensively by Bernafon, and have been found to fulfil the minimum requirements for compatibility at the time of testing. However, Bernafon takes no responsibility for such compatibility in general. Specifically, Bernafon shall not be responsible for incompatibility resulting from future updates of the mobile phones, nor from events of incompatibility not covered by and/or found in these tests. Bernafon takes no financial responsibility in terms of reimbursements of mobile phones that do not work as expected. Before purchasing a new mobile phone, you are advised to consult the list mentioned above.

Technical information

Model name	AC1A
GTIN	05714464006786
Conditions of Use	
FCC/IC	FCC ID: 2ACAHAC01 IC: 11936A-AC01
Compatibility	Bernafon 2.4 GHz wireless hearing instruments
Dimensions	53 x 27 x 18 mm; weight 27g
Operating conditions	Temperature: +5°C to +40°C (41°F to 104°F) Humidity: 15% to 93%, relative humidity, non-condensing Atmospheric pressure: 700 hPa to 1060 hPa
Storage and transportation conditions	Temperature and humidity shall not exceed the below limits for extended periods during transportation and storage: Temperature: -20 °C to +60 °C (-4 °F to +140 °F) Humidity: 15% to 93%, relative humidity, non-condensing Atmospheric pressure: 700 hPa to 1060 hPa

System features	Mobile phone headset (handsfree/headset profile) & stereo music (A2DP) Remote/Partner microphone
Remote control of HI	Volume, program shift and mute of microphones in hearing instruments
Battery ¹	Typical daily use 16 hours: 2 hours audio streaming + 2 hours phone + 12 hours standby 36 h standby (turned on, no streaming) Charge time: 2 hours Battery total life expectancy: 80% capacity left after 720 charge/re-charge cycles
Audio quality ²	Stereo/20 kHz sample freq.
Audio bandwidth ²	80 Hz – 10 kHz
Pairing details	Up to 8 paired Bluetooth® devices
Bluetooth® compliance	Version 4.2 + EDR
Bluetooth® profile support	Advanced Audio Distribution Profile (A2DP) 1.3 Headset Profile (HSP) 1.2 Hands-Free Profile (HFP) 1.6 including support for Wideband Speech
Wireless range ³	10 meters with Bluetooth® Class 2 devices (e.g. mobile phones) up to 20 meters between SoundClip-A and hearing instruments
Streaming frequency	2.4 GHz (Bluetooth® band)

Emissions	Max. 17 dBm e.i.r.p. in compliance with all relevant standards
Status indications	LEDs on the SoundClip-A. Acoustic signals in hearing instruments
Oasis ^{next} 2017.2 (or later)	Fitting of streaming programs

¹ Using the supplied charger

² Actual audio performance depending on client's hearing instruments

³ Free line of sight between the SoundClip-A and other devices. Other devices operating in the 2.4 GHz band may interfere and reduce range.

The SoundClip-A contains a radio transceiver using Bluetooth, Bluetooth Low Energy (BLE) and a proprietary short range radio technology both working at ISM band 2.4 GHz. The GHz radio transmitters are weak and always below 50mW equal to 17 dBm in total radiated power. The SoundClip-A complies with international standards concerning radio transmitters, electromagnetic compatibility and human exposure.

Due to the limited space available on the SoundClip-A, relevant approval markings can be found in this booklet.

USA and Canada

This device contains a radio module with the following certification ID numbers:

FCC ID: 2ACAHAC01

IC: 11936A-AC01

The device complies with Part 15 of the FCC Rules and with Industry Canada's licence-exempt RSSs. Operation is subject to the following two conditions:

1. this device may not cause harmful interference, and
2. this device must accept any interference received, including interference that may cause undesired operation.

Changes or modifications not expressly approved by the party responsible for compliance could void the user's authority to operate the equipment.

International warranty

Your device is covered by an international limited warranty issued by the manufacturer for a period of 12 months from the date of delivery to you. This limited warranty covers manufacturing and material defects in the device itself, but not in accessories such as batteries, cables, power supplies, etc.

Problems arising from improper/incorrect handling or care, excessive use, accidents, repairs made by an unauthorised party, exposure to corrosive conditions, damage due to foreign objects entering the device, or incorrect adjustments are NOT covered by the limited warranty and may void it.

Under this warranty, the manufacturer will choose, at its sole discretion, whether to repair the device, or replace it with an equivalent model. The above warranty does not affect any legal rights that you might have under applicable national legislation governing sale of consumer goods. Your hearing care professional may have issued a warranty that goes beyond the clauses of this limited warranty. Please consult him/her for further information.

If you need service

Take your device to your hearing care professional, who may be able to sort out minor problems and make adjustments immediately. Your hearing care professional can assist you to obtain warranty service from the manufacturer. Your hearing care professional may charge a fee for their services.

Australia only

The rights given under this warranty are in addition to other rights and remedies under a law in relation to the good or services to which the warranty relates to. Our goods come with guarantees that cannot be excluded under the Australian Consumer Law. You are entitled to a replacement or refund for a major failure and compensation for any other reasonably foreseeable loss or damage. You are also entitled to have the goods repaired or replaced if the goods fail to be of acceptable quality and the failure does not amount to a major failure.

Australian customers should contact:
Bernafon Australia at 629 Nudgee Road, Nundah,
QLD 4012. Telephone: 1800 809 111 if you have
any questions regarding this warranty.

Name of owner:

Hearing care professional:

Hearing care professional's adress:

Hearing care professional's phone:

Purchase date:

Model:

Serial no.:

The manufacturer declares that this SoundClip-A (AC1A) is in compliance with the essential requirements and other relevant provisions of Directive 2014/53/EU. This medical device complies with Medical Device Regulation (EU) 2017/745. The Declaration of Conformity is available from the manufacturer.



Manufacturer:

SBO Hearing A/S
Kongebakken 9
DK-2765 Smørum
Denmark
www.sbohearing.com

Australian Sponsor

Audmet Australia Pty Ltd

Level 5
11 Khartoum Road
Macquarie Park NSW 2113









Complies with
IMDA Standards
DA103820











Waste from electronic equipment must be handled according to local regulations.



Description of symbols used in this booklet or on the packaging label

	<p>Warnings Text marked with a warning symbol must be read before using the device.</p>
	<p>Manufacturer The device is produced by the manufacturer whose name and address are stated next to the symbol. Indicates the medical device manufacturer, as defined in EU Regulations 2017/745 and 2017/746.</p>
	<p>CE mark The device complies with all required EU regulations and directives.</p>
	<p>Electronic waste (WEEE) Recycle hearing aids, accessories or batteries according to local regulations. Hearing aid users can also return electronic waste to their hearing care professional for disposal. Electronic equipment covered by Directive 2012/19/EU on waste and electrical equipment (WEEE).</p>
	<p>Regulatory Compliance Mark (RCM) The device complies with electrical safety, EMC and radio spectrum requirements for devices supplied to the Australian or New Zealand market.</p>
	<p>Double insulation Indicates that product power supply is double insulated. This means a very low risk of single fault failures i.e. single fault failures cannot occur.</p>
	<p>Indoor use Indicates that the product is qualified for indoor use.</p>
	<p>Battery recycling symbol Li-Ion Battery recycling symbol.</p>

	<p>Singapore IMDA label Indicates that the device complies with the standards and specification published by Info-Communications Media Development Authority (IMDA) and is compatible with the public telecommunication networks in Singapore and does not cause radio frequency interference to other authorized radio-communication networks.</p>
	<p>South Africa ICASA label Indicates that the device has license to be sold in South Africa.</p>
	<p>Japan TELEC symbol Indicates mark for certified radio equipment.</p>
	<p>Brazil ANATEL label Indicates that the device is certified and homologated in Brazil.</p>
	<p>Medical Device The device is a medical device.</p>
	<p>Keep dry Indicates a medical device that needs to be protected from moisture.</p>
	<p>Catalogue number Indicates the manufacturer's catalogue number so that the medical device can be identified.</p>
	<p>Serial number Indicates the manufacturer's serial number so that a specific medical device can be identified.</p>
<p>Rated input: 5,0 V \approx 0,4 A</p>	<p>Power supply outlet Indicates the rate at which power is sent from the outlet to your electrical device.</p>
	<p>Unique device identifier Indicates a carrier that contains unique device identifier information</p>

< >
8,15 mm

Placeholder
for FSC logo

^
19 mm
v

< 15 mm >

9.0 mm

World Headquarters

Bernafon AG

Morgenstrasse 131
3018 Bern
Switzerland
www.bernafon.com



0000225266000001

bernafon 
Your hearing • Our passion